

Procedure to connect SECURED-VTC network for Android

1. In the Settings > Connections > WiFi



2. Tap the "ON/OFF" to enable the Wi-Fi.



3. Connect SECURED-VTC



4. Enter wireless network information

- EAP method: PEAP
- Phase 2 authentication: MSCHAPV2
- Identity: Your CNA account < CNA >
- Enter password: Your CNA Account Password.

Select Connect

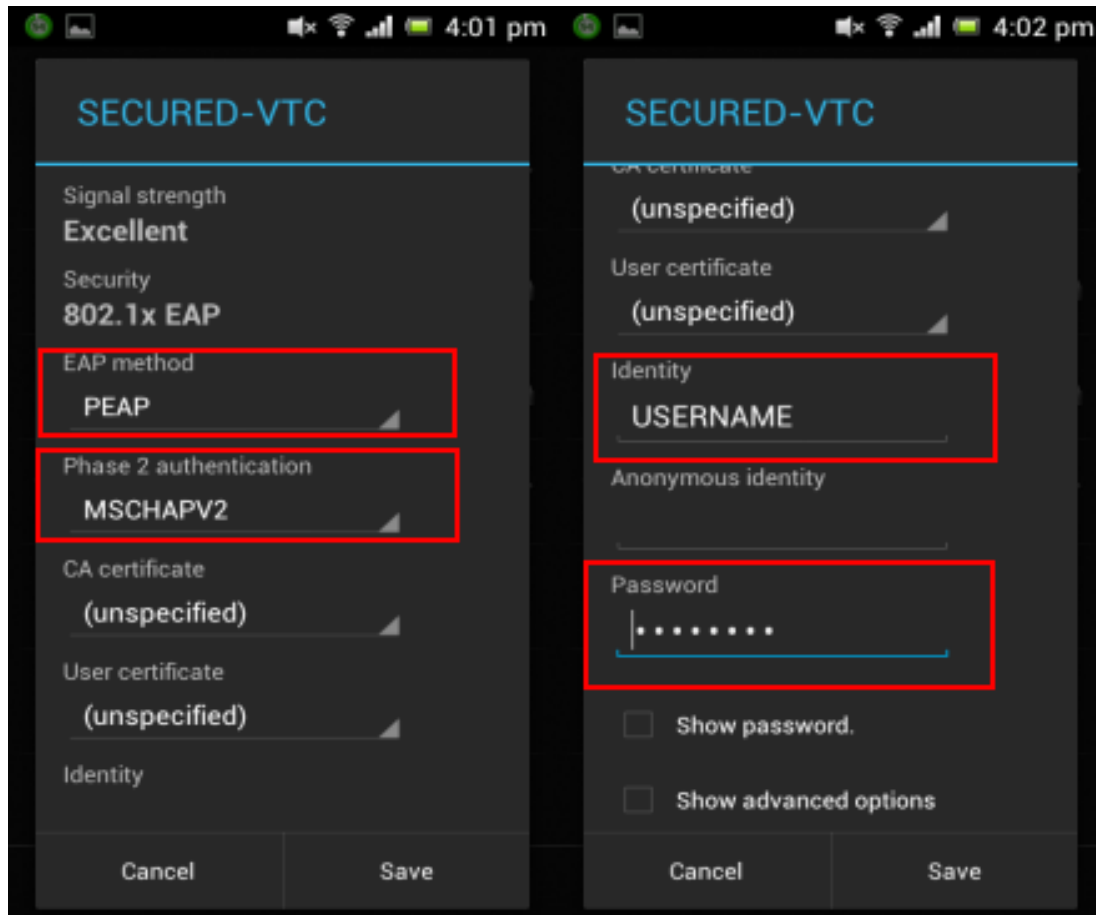

5. The status of SECURED-VTC now changes to Connected

